



8960 SASHABAW RD

CLARKSTON, MI 48348

RETAIL BUILDING FOR SALE/LEASE

- Brand New 2,241 square foot retail building on Sashabaw Road
- Selling two parcels separate or together
- Combined Pricing: \$650,000.00
- Combined Acres: 1.38 Acres
- Parcel 1): \$550,000.00
 - 08-10-401-015
 - Zoning: C-1: Local Commercial
 - A variety of uses are approved such as fast food, shopping center, and any business that sells "commodities" (meat, dairy, baked goods, appeal, hardware, etc.), fitness, drive-thru, and more.
 - Brand new retail building totaling 2,241 square feet.
 - Acres: 0.69
- Parcel 2): \$125,000.00
 - 08-10-401-014
 - Zoning: R-1A: Single Family Residential
 - Acres: 0.69

- **Population**
1 Mile: 999
3 Mile: 21,720
5 Mile: 66,945
- **Business**
#of Businesses: 26
of Employees: 160
- **Household**
1 Mile: 329
3 Mile: 7,565
5 Mile: 24,650
- **Annual Household Income**
1 Mile: \$143,314
3 Mile: \$133,713
5 Mile: \$123,076
- **Traffic Count**
Sashabaw Road: 11,197

Kevin Tamer
Vice President /
Associate Broker
Office: 248-710-8000
Cell: 734-624-3729
knt@team-core.com

Samuel McLean
Vice President
Office: 248-710-8000
Cell: 248-935-7237
sam@team-core.com



Kevin Tamer
 Vice President /
 Associate Broker
 Office: 248-710-8000
 Cell: 734-624-3729
 knt@team-core.com

Samuel McLean
 Vice President
 Office: 248-710-8000
 Cell: 248-935-7237
 sam@team-core.com

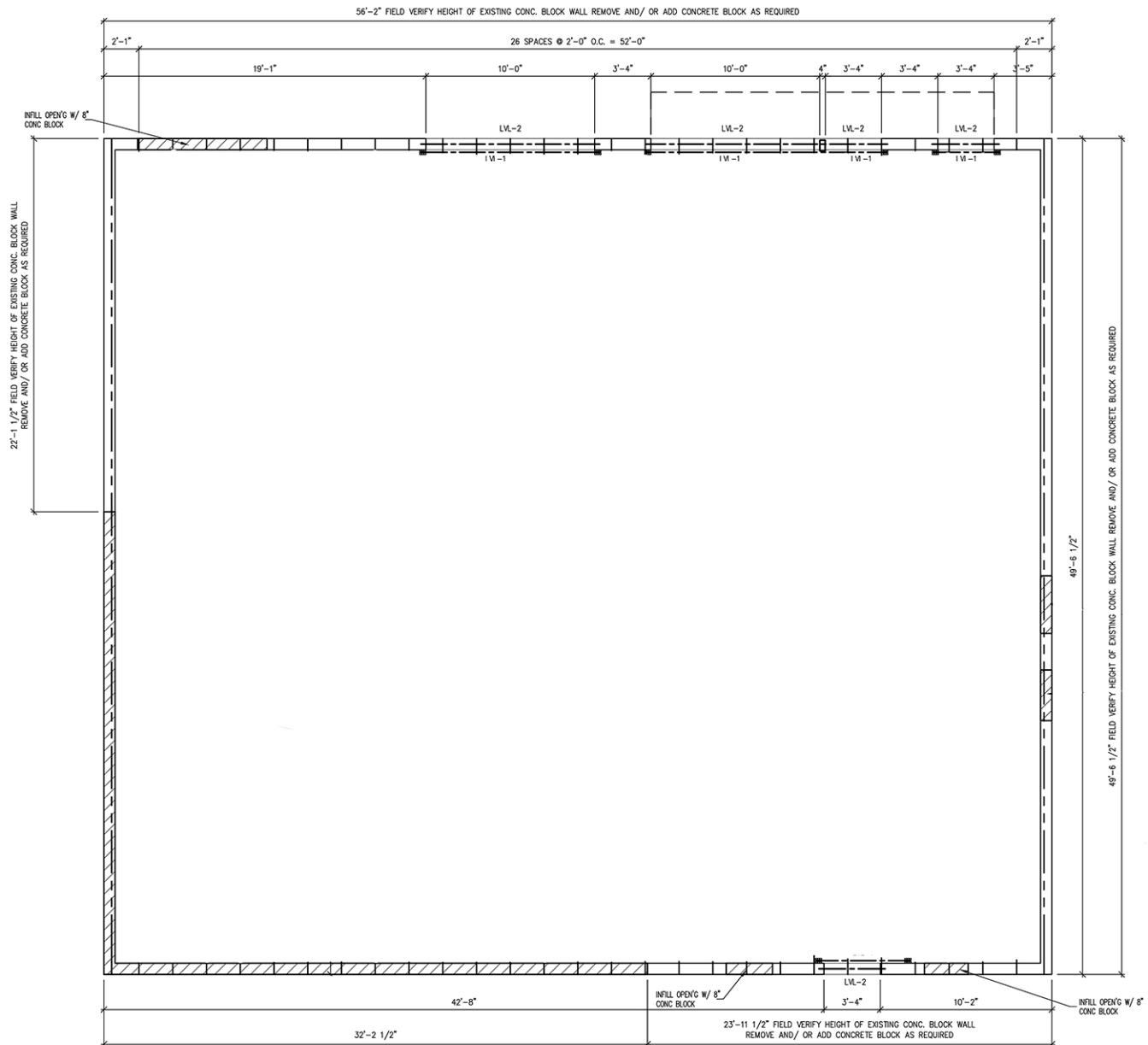

DO NOT SCALE



8960 Sashabaw Road
Clarkston, MI 48348

2,241 SF
For More Information Please Call:
248.710.8000

